

Technical Data Sheet

Bactident® Aminopeptidase for the detection of L-alanine aminopeptidase in microorganisms

Ordering number: 1.13301.0001

Content: 50 test strips

Composition:

The reaction zone of a test strip contains:
L-alanine-4-nitroanilide 0,5 µmol; buffering agents

Principle

L-alanine aminopeptidase is an enzyme which is localized in the cell envelope of bacteria and which is found in relevant activities almost exclusively in Gram-negative microorganisms. This enzyme splits off the amino acid L-alanine from various substrates.

In the case of these test strips, the substrate L-alanine- 4-nitroanilide is split into 4-nitroaniline and the amino acid L-alanine in the presence of alanine aminopeptidase. The presence of the L-alanine aminopeptidase is indicated by the yellow coloration of the 4-nitroaniline.

The results of the investigations performed so far indicate that there is a very good correlation between the aminopeptidase reaction and the Gram-behavior of the microorganisms.

Use

Suspend a thickly grown individual colony (about 2 mm Ø) in 0.2 ml of distilled water to give an opalescent mixture.

Note: Only bacterial colonies without strong intrinsic colorations should be used for the aminopeptidase test.

We recommend that a control test with an aminopeptidase-positive bacterium (e.g. *E.coli*) and an aminopeptidase-negative bacterium (e.g. *Staphylococcus aureus*) should always be carried out at the same time as the main test.

Stability

See expiry date

Only remove the amount of strips needed at the time!

Do not touch the reaction zones of the test strips. Close receptacle firmly immediately after use. Please store at the specified temperature.

Safe removal

The test strip is to be removed safely after use like bacteria containing material. This may be done by burning, autoclaving or by placing into a 5 to 6% disinfectant solution - for at least 6 hours.

Procedure

- Using an inoculating loop, remove an individual, thickly grown colony from the nutrient medium (fig. 1).
- In a small test tube, suspend the bacterial mass in 0.2 ml of distilled water (fig. 2).
- Insert the aminopeptidase test strip into the test tube such that the reaction zone is completely immersed in the bacteria suspension (fig. 3).
- Incubate the test tube in a water bath (or incubation cupboard) for 10 to a maximum of 30 minutes* at 37 °C.
- Read off the reaction by comparison with the color scale (fig. 4)

- * A clear yellow coloration of the bacteria suspension can be seen after only 10 minutes in the case of most aminopeptidase-positive microorganisms; if no yellow coloration appears within this time, the incubation should be extended to a maximum of 30 minutes so that the weakly aminopeptidase-positive strains can be recognized or the absence of Gram-negative microorganisms can be confirmed (see table for exceptions).

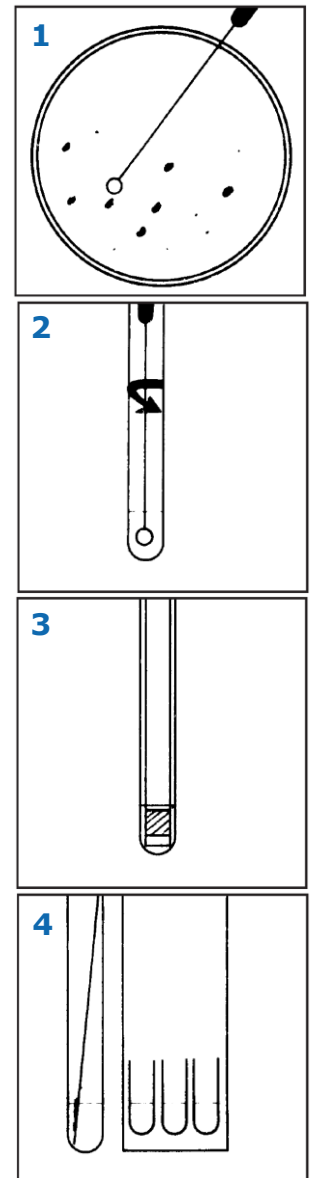

Aminopeptidase-positive strains*

all Gram-negative microorganisms

The suspension of bacteria turns yellow if L-alanine amino-peptidase-positive organisms are present.

Exceptions: *Bacteroides vulgatus*, *Bacteroides fragilis*, *Campylobacter* species, *Veillonella parvula*

Aminopeptidase-negative strains*

all Gram-positive microorganisms

*acc. to the results of investigations performed so far.